



DESCRIPTION

These wipes are premoistened with a powerful formula designed to clean and polish stainless steel surfaces while protecting them against the damaging effects of oxidation and corrosion.

They will remove hard-water stains, smudges, fingerprints, food spills and residue from virtually any stainless steel surface or appliance. As they clean, they also brighten, polish and protect the surface with a clear coating that acts as a protective shield.

These wipes also work on other types of metals including brass, silver, chrome, and copper.

Avoid breathing fume. Contaminated work clothing must not be allowed out of the workplace. Wear eye protection, protective gloves.

IF SWALLOWED: Immediately call a doctor, POISON CENTER. Do NOT induce vomiting.

IF ON SKIN: Wash with plenty of water. If skin irritation or rash occurs: Get medical advice/attention. Take off contaminated clothing and wash it before reuse.

In case of fire: Use foam, carbon dioxide (CO₂), dry extinguishing powder to extinguish.

Store in a well-ventilated place. Keep cool. Store locked up.

*For industrial and commercial use only.
For additional information, see Safety Data Sheet.*

TOTAL SOLUTIONS®

WET WIPES

STAINLESS STEEL CLEANER WIPES

VOC-Compliant Formula

- FORMULATED FOR MORE EVEN COVERAGE
- PREVENTS WATER MARKS AND CORROSION
- CLEANS AND POLISHES

KEEP OUT OF REACH OF CHILDREN

DANGER

May be fatal if swallowed and enters airways.
May cause an allergic skin reaction.

See side panel for additional safety information.

NET CONTENTS: 40

9.5" x 12" (24.13 cm x 30.48 cm) Premoistened Wipes

Manufactured By: Total Solutions®
PO Box 240014 • Milwaukee, WI 53224
1-800-743-6417

DIRECTIONS

Scrub surface with abrasive side of towel until stains and deposits disappear. Use the smooth side to wipe the surface clean. Discard used towel. For a super shine, buff lightly with a soft, dry towel after application.

DIRECTIONS FOR DISPENSING

1. Remove lid by lifting upward. Remove foil seal.
2. Pull towel from center of the roll and thread through "X" on the underside of the lid.
3. Close lid. Pull towel at 90° angle.
4. Snap hinged cap back into place to ensure towels stay moist.

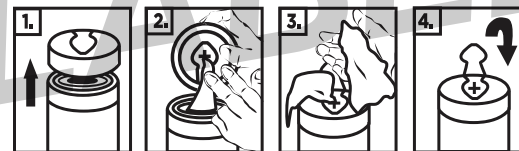

Dispose of contents/container to comply with local/regional/national/international regulations. Do not flush wipes.

NFPA® RATINGS

Health: 1; Flammability: 2; Reactivity: 0

CONTAINS/CAS NUMBER:

Isoparaffinic Hydrocarbon/64742-47-8; White Mineral Oil/8042-47-5; Blend of Nonionic Esters/Proprietary; D-limonene/5989-27-5; Perfumery Compound/Mixture



Please Recycle.

Canister made from 25% post-consumer recycled plastic.

1549.051115